

# U.S. Encryption Export Controls Seminar and Counseling

## U.S. Encryption Export Controls Seminar

2008/1/22(Tue)

Tokyo Big Site Conference Tower 6F

10:30 ~ 10:35	Welcome & Introduction  Tsutomu Oshida Executive Managing Director Center for Information on Security Trade Control (CISTEC)
10:35 ~ 12:00	U.S. Encryption Export Controls <ul style="list-style-type: none"><li>• License Exception “ENC”</li><li>• Pre-export technical review requirement</li><li>• “Restricted” Definition</li><li>• Government End-User</li><li>• Electronic Download Compliance</li><li>• Open Crypto APIs</li></ul> Roszel C. Thomsen II Partner THOMSEN AND BURKE LLP
12:00 ~ 13:00	Lunch Break (Lunch will not be provided. )
13:00 ~ 14:00	U.S. Encryption Export Controls (Future) <ul style="list-style-type: none"><li>• 2008 Decontrol Proposal (Positive List, Exclusion Note) (Industry, BIS)</li></ul> Roszel C. Thomsen II Partner THOMSEN AND BURKE LLP
14:00 ~ 14:10	Break
14:10 ~ 15:40	More Export Controls <ul style="list-style-type: none"><li>• Recent Trends in “ Deemed ” Exports</li><li>• DEAC Recommendations</li></ul> Roszel C. Thomsen II Partner THOMSEN AND BURKE LLP
15:40 ~ 15:50	Break
15:50 ~ 16:30	Panel Session - From FAQ to Encryption Trend  Roszel C. Thomsen II Partner THOMSEN AND BURKE LLP

Fumio Kudo  
Senior Manager  
Security Trade Control Div.  
NEC Corporation

Ichiro Ayukawa  
Deputy Director  
Technical Administration Div.  
Security Export Control HQ  
Fujitsu LTD

Naobumi Yamada  
Senior Manager  
Export Control Div.  
Information & Telecommunication Systems  
Hitachi, Ltd.

<MODERATOR>  
Hiroshi Nakao  
Deputy General Manager  
Export Services Department  
Center for Information on Security Trade Control (CISTEC)

Moe Kato  
Researcher  
Center for Information on Security Trade Control (CISTEC)

All sessions are provided with consecutive interpretation.

TOKYO BIG SITE - <http://www.bigsight.jp/english/index.html>

Conference Tower <http://www.bigsight.jp/english/organizer/index.html>

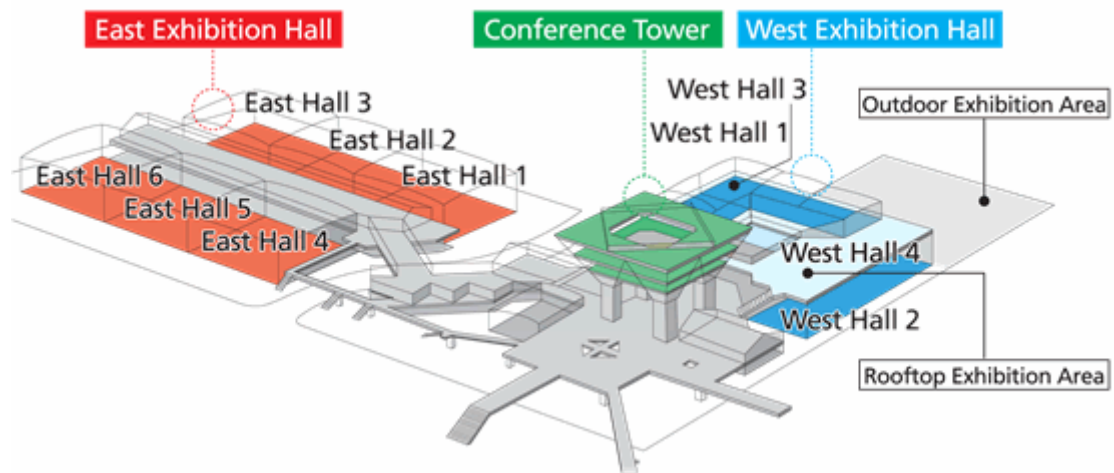

Conference Rooms [http://www.bigsight.jp/english/organizer/guide/guide\\_meeting.html](http://www.bigsight.jp/english/organizer/guide/guide_meeting.html)

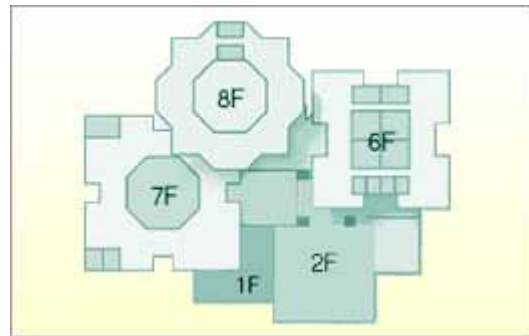

ACCESS - <http://www.bigsight.jp/english/organizer/access/index.html>

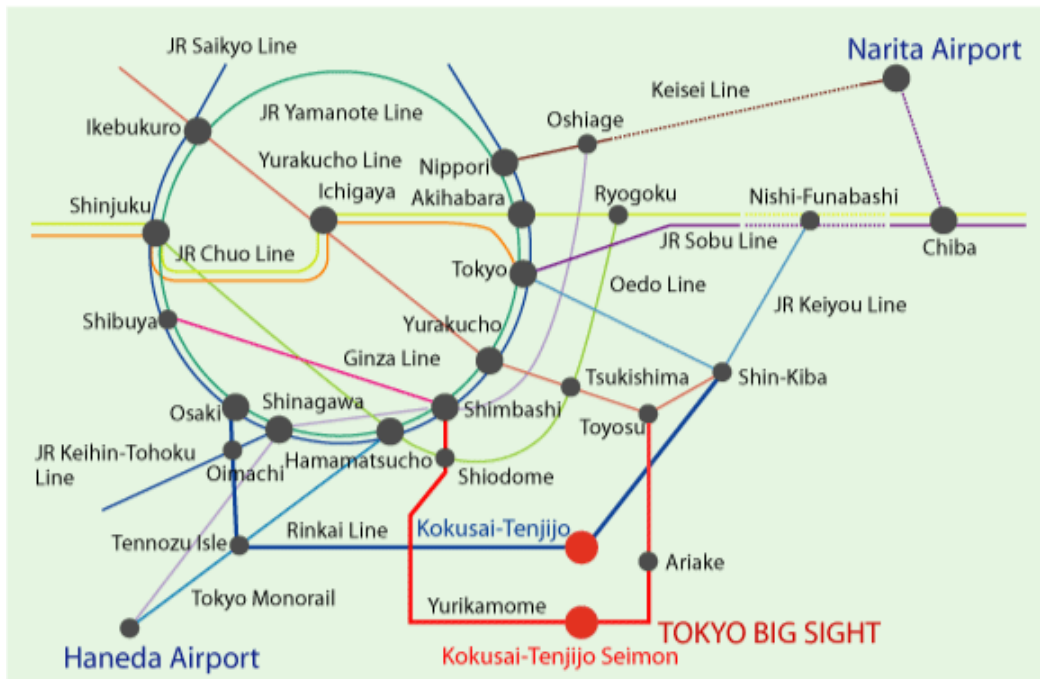

## ■ By Train

---

### [Rinkai line](#)

About 7-mins. walk from Kokusai-Tenjijo Station

Osaki Sta. (JR) 13 mins. Kokusai-Tenjijo Sta. 5 mins. Shin-Kiba Sta.(JR,Subway)

\* Direct service at Osaki to JR Saikyo Line

Kokusai-Tenjijo Sta. JR Shibuya Sta. (about 20 mins.)  
JR Shinjuku Sta. (about 25 mins.)  
JR Ikebukuro Sta. (about 31 mins.)

### [Yurikamome](#)

About 3-mins. walk from Kokusai-Tenjijo-Seimon Station

Shimbashi Sta. (JR, Subways) 22 mins. Kokusai-Tenjijo Seimon Sta.

Toyosu Sta. (Subway) 8 mins. Kokusai-Tenjijo Seimon Sta.

## ■ By Bus

---

### [Toei Bus](#)

Tokyo Sta. (Yaesu Exit, JR) about 35 mins. Tokyo Big Sight

Monzen-Nakacho Sta. (Subway) about 30 mins. Tokyo Big Sight

Hamamatsucho Sta. (JR, Monorail) about 30 mins. Tokyo Big Sight

### [Airport Bus](#) ( [Limousine Bus](#) · [Keihin Kyuko Bus](#) )

[Haneda Airport](#) about 25 mins. Tokyo Big Sight (Limousine Bus, Keihin Kyuko Bus)

[Narita Airport](#) about 60 mins. Tokyo Big Sight (Limousine Bus)

[Tokyo City Air Terminal](#) about 20 mins. Tokyo Big Sight (Limousine Bus)

Some buses only run during events. Please check in advance.

### [Express Bus \(Keihin Kyuko Bus\)](#)

Yokohama Sta. (East Exit, JR) about 50 mins. Tokyo Big Sight (Keihin Kyuko Bus)

## ■ By Water Bus

---

### [Water Bus](#)

Hinode Pier (about 7 mins. walk from JR Hamamatsucho Station) 25 mins. Tokyo Big Sight 10 mins. Palette Town

## ■ By Car

---

### From center of Tokyo

About 20 mins. from Tokyo Sta. (JR, Subway)

### From Yokohama/Haneda

About 15 mins. from Haneda Airport

### From Chiba/Kasai

Metropolitan Expressway (Wangan Line) about 5 mins. from the Ariake Ramp

## U.S. Encryption Export Controls Counseling

2008/1/23(Wed)

CISTEC Conference Room 2

9:30 ~ 12:20	U.S. Encryption Export Controls  Roszel C. Thomsen II Partner THOMSEN AND BURKE LLP